

soft top jaws

steel ■ aluminium

INCH serration
1/16" x 90° or 3/32" x 90°

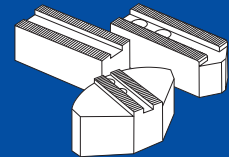

hard top jaws

INCH serration
1/16" x 90° or 3/32" x 90°

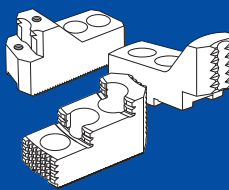

soft top jaws

steel ■ aluminium

METRIC serration
1,5 x 60° or 3 x 60°

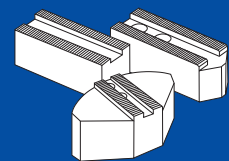

hard top jaws

METRIC serration
1,5 x 60° or 3 x 60°

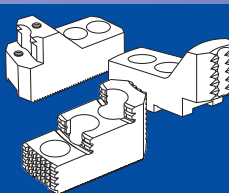

- T-nuts
- grippers

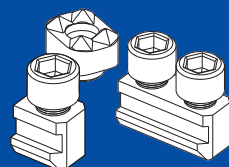

soft top jaws

tongue & groove

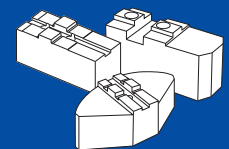

hard top jaws

tongue & groove

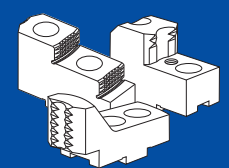

quick jaw change

for manual and power chucks
straight modular serration System SMW/Reishauer

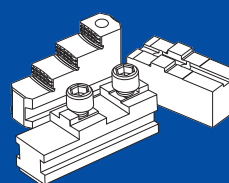
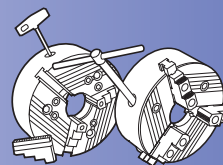

quick jaw change

for manual and power chucks
helix modular serration System Forkardt

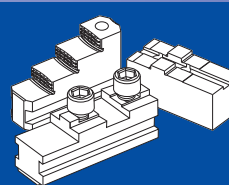
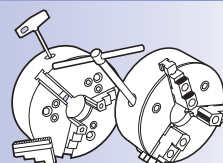

- special jaws
- boring rings
- dress and cleaning plate
- calculations

