

T-nuts

NST



quenched and ground

incl. screw
DIN 912 – 12.9

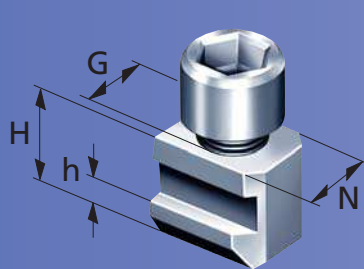

version 1

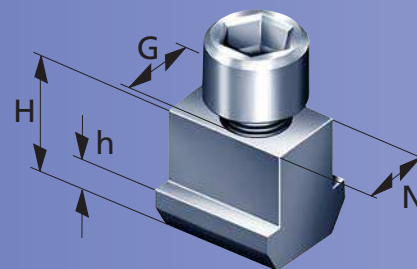

version 2

Type	Id.-No.	vers.	N	H	h	G	screw DIN 912	torque Md max. (Nm)	SMW-AUTOBLOK	SMW	Autoblok
NST 11	013862	2	11	21,5	7,5	M8	M8 x 30	30		SP 125 • STP 125 STWP 125	
NST 12	081966	2	12	17	7	M8	M8 x 20	30		KDV 130	
NST 12-1	089810	2	12	21,5	7,5	M8	M8 x 25	30	SP 125/98 • STP 125		
NST 14	013863	2	14	26,5	9,5	M10	M10 x 35	50	SP 160 • STP 165	SP 160 • STP 160 STWP 160	
NST 14-1	085874	2	14	20	7,5	M10	M10 x 25	50			ODN 170 • HDB 170 ODL 170 • HDN 170 HDL 170 • GHDN 165 GHD/FC 165
NST 14-2	035958	1	14	18,5	6,5	M10	M10 x 20	50	HFKN-D 165 • AN-D 165 AL-D 165 • BH-D 165 BHD-FC 165 • BB-D 175 HB-D 165 • PB-D 165 AP/NT-D 170 PBI-D 165 • HYDN-S 180		
NST 17-5	064921	1	17	18,5	6,5	M12	M12 x 25	70	HFKN-D 165		
NST 17	016021	2	17	23	9	M12	M12 x 30	70		HFK 160/200 HFKS 160/200 KDV 160/200/250 KDVG 160/200/250 KFV 160/200 KFMF 160/200	
NST 17-1	085877	2	17	22,3	8,3	M12	M12 x 30	70			ODN 200 • ODN 220 ODL 200 • HDB 200 HDN 200 • HDN 220 HDL 200 • GHDN 210 CD 200 • GHD/FC 210
NST 17-2	034245	1	17	20,5	7,5	M12	M12 x 25	70	HFKN-D 210 • AN-D 210 AL-D 210 • BH-D 210 BHD-FC 210 • BB-D 210 HB-D 210 • PB-D 210 PBI-D 210 AP/APL/NT-D215/260 RC-D210 HYDN-S 210/226		
NST 17-14	036976	1	17/1420,5	7,5	M12	M12 x 25	M12 x 25	70			
NST 17-3	081825	2	17	21,5	9	M12	M12 x 25	70			
NST 17-4	013864	2	17	26,5	9,5	M12	M12 x 30	70	SP 200 • SP 240 STP 240 • CC 240 Z	SP 200 • STP 200 STWP 200 • LP 205	
NST 21	014788	2	21	27	11	M16	M16 x 35	150		HFK 250/270/315 HFKS 250/315 KDV 315/400 KDVG 315/400 KZF-ES 200 KZF 200 KFV 250/315 KFMF 250/315	
NST 21/17	081812	3	21/17	27	11	M12	M12 x 35	70			