

T-nuts NST

quenched and ground

incl. screw
DIN 912 – 12.9

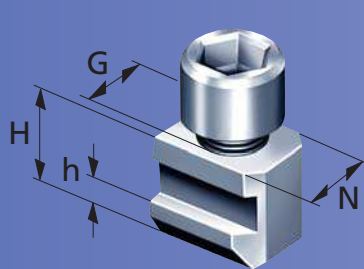

version 1

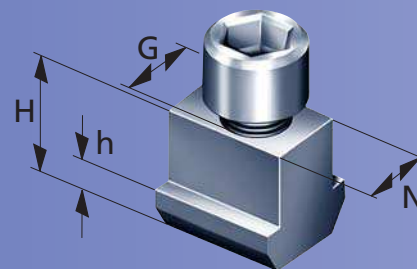

version 2

Type	Id.-No.	vers.	N	H	h	G	screw DIN 912	torque Md max. (Nm)	SMW-AUTOBLOK	SMW	Autoblok
NST 21-3	081826	2	21	25,5	11	M16	M16 x 35	150	GH-D 400 GH-M 400 RC-D 400 RC-M 400		ODN 250-315-400 ODL 250-315-400 HDN 250-315-400 HDL 250-315-400 GHDN 250-315-400 GHD/FC 250-305-400 CD 250/315 • HDB 300 2 CLD 200 • US-2 CLD 200
NST 21-5	033429	2	21	30	11	M16	M16 x 35	150	SP 250/98 SP 350 STP 250/98 • STP 280 SP 280/350	SP 250/315 LP 250/305 STP 250/315 STWP 250/315	
NST 21-6	034197	1	21	26,5	10	M16	M16 x 35	150	HFKN-D 260/315 AN-D 250/315 AL-D 250/315 AN-M 315 • AL-M 315 HB-D 250/315 NT-D 315 • NT-M 315 AP-D 315 • AP-M 315 APL-D 315 • APL-M 315 BH-D 250/315 BHD-FC 250/315 BH-M 315 • BB-M 315 PB-D 250/315 BB-D 250/315 RC-D 250/305 BHM-FC 315 • RC-M 305 PBI-D 250/315 HYDN-S 250/315		
NST 21/17-1	034208		21/17	26,5	10	M12	M12 x 30	70			
NST 25	014812	2	25,5	29	11	M20	M20 x 40	300	HFKN-D 400 HFKN-D 500	HFK 400/500 HFKS 400/500 KDV 500 • KDVG 500 KDS 630 • KZF 250 KZF 315/400 KZF-ES 315/400 KFV 400/500 KFV 630/800	
NST 25-1	013866	2	25,5	34,5	14,5	M18	M18 x 55	220		STP 400/500 LP 380/460/500 BB 400/500 BB 400/500-ES	
NST 25-3	12065020	2	25,5	34	15	M20	M20 x 40	300	AN/AL-D 400 BB-N 400/460/500/600 BB-N ES 400/460/500/600 BH-D 400/450/500/630/800 BHD-FC 400/450/500/630/800 CL-D 250/315 HYD-S 400	2 CLD 250/315 US-2 CLD 250/315	
NST 25-4	12065002	3	25,5	40	15,5	M20	M20 x 50	300	GHDN 610/640/800 HYDL-S 800 IN-D 500/630/800 IL-D 500/630/800		
NST 25-5	199908	2	25,5	40	15	M20	M20 x 50	300	BB-AZ 590 BB-SC 600		
NST 30	081811	2	30	41	15	M24	M24 x 50	450			
NST 30-1	014827	2	30	36	15	M24	M24 x 50	450		HFKS 630/800	
NST 30-2	013868	2	30	41	15	M24	M24 x 70	450			
NST 30-3	13063900	2	30	44	18	M24	M24 x 60	450	BB-N 630/800/1000 BB-N ES 630/800/1000 IN-D 1000/1250 BBU-AZ 630/750	STP 630/800 BB 630/800/1000 BB-ES 630/850/1000	