

Main dimensions and technical data

Jaw position: Open for external clamping

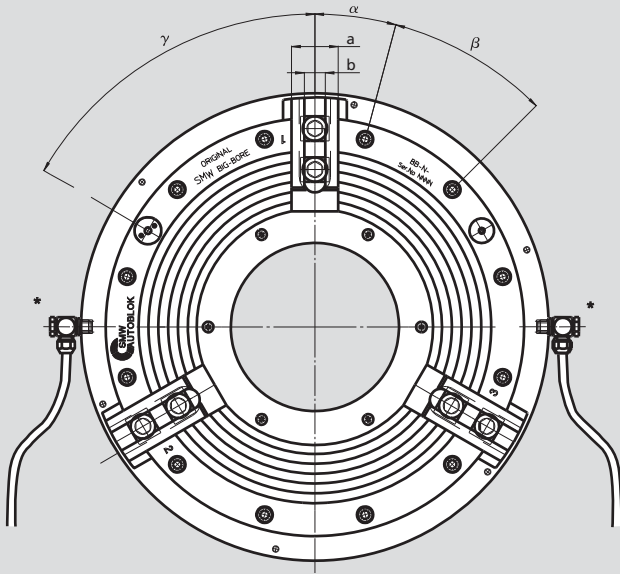

*all hoses must be min. Ø 14 mm i.d.

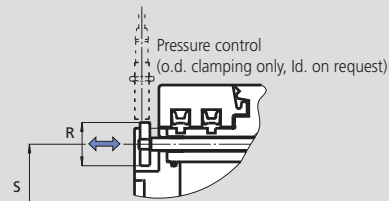
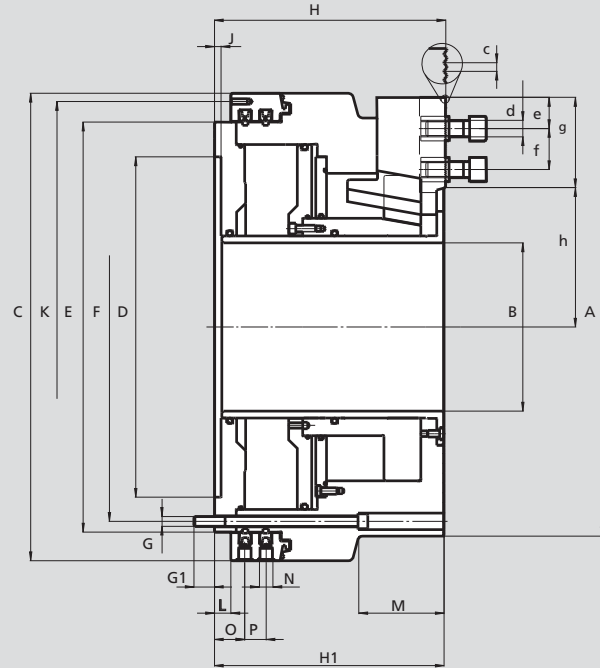

enlarged illustration

Jaw stroke control on request
Subject to technical changes
For more detailed information please ask for customer drawing

SMW-AUTOBLOK BB-N Type			400-140	470-191	500-205	500-230	600-275	630-310	800-410
Id. No.			052300	053535	052318	052340	052989	052534	052347
Mounting			Z310	Z310	Z415	Z415	Z450	Z510	Z700
	A	mm	422	470	540	570	605	662	800
	B	mm	140	191	205	230	275	310	410
	C	mm	467	467	570	570	605	685	850
	D H6	mm	310	310	415	415	450	510	700
Fixing bolts circle	E	mm	400	400	500	500	535	610	775
	F	mm	374	374	474	474	508	580	745
	G	mm	M12	M12	M12	M12	M12	M16	M16
	G1	mm	26	26	26	26	25	30	30
	H	mm	196	196	225	225	225	263	305
	H1	mm	194	194	223	223	223	261	303
Thread circle 6x M8	J	mm	8	8	8	8	8	8	8
	K	mm	448	448	550	550	585	666	830
	L	mm	20	20	20	20	20	20	25
Pneumatic connection	M	mm	70	-	98	98	-	115	154
	N	inch	G 1/2"	G 1/2"	G 1/2"	G 1/2"	G 1/2"	G 1/2"	G 1/2"
	O	mm	37	37	37	37	37	39.5	44.5
	P	mm	26	26	26	26	26	33	33
	R	mm	35	35	35	35	35	42	35
	S	mm	374	374	474	475	508	575	745
Serration	a	mm	57	57	57	57	57	75	75
	b	mm	25.5	25.5	25.5	25.5	25.5	30	30
Bolt DIN 912 12.9	c	inch	3/32" x 90°	3/32" x 90°	3/32" x 90°	3/32" x 90°	3/32" x 90°	3/32" x 90°	3/32" x 90°
T-nuts distance	d	mm	M20	M20	M20	M20	M20	M24	M24
	e	mm	13	13	14	14	14	16	16
Serration length	f	mm	38/85	38/85	38/102	38/102	38/94	47/103	47/130
	g	mm	117.5	117	138	138	130	142	171.5
(Pressure control)	h	mm	94.5/101.5	124/131	133.5/142	143.5/152	165/173.5	190.5/200.5	243/255
	alpha°		20	20	15	15	15	15	15
	beta°		9 x 40	9 x 40	12 x 30	12 x 30	12 x 30	12 x 30	12 x 30
	gamma°		37	83	60	60	60	60	60