

BIG BORE® BB-FZA

Front-end pneumatic 6-jaw sequence chucks Ø 275 - 378 mm

■ 3 integrated centering jaws and 3 compensating jaws



Application/customer benefits

- High efficiency machining of bent or straight pipe
- Fast jaw movement for short cycle times = more pipe per hour
- Full spindle bore can be used

Technical features

- 3+3 jaw air chuck with 3 integrated centering jaws and 3 compensating jaws
- Integrated centering jaws move axially forward to center the tube exactly at the area to be threaded
- For external clamping only
- Fully automatic sequence is programmable

Machining of bent pipe with chuck with integrated centering jaws:

1

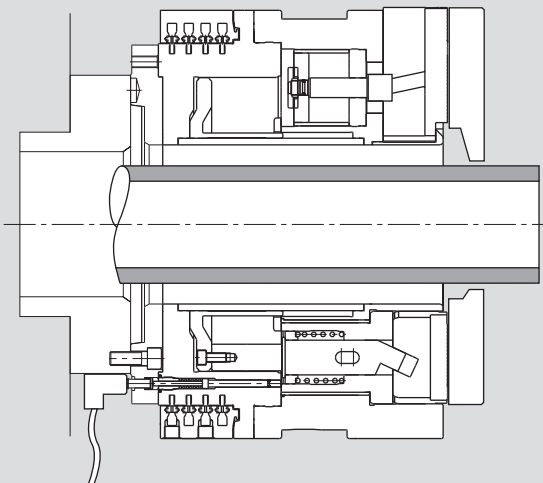

Chuck open, load pipe

2

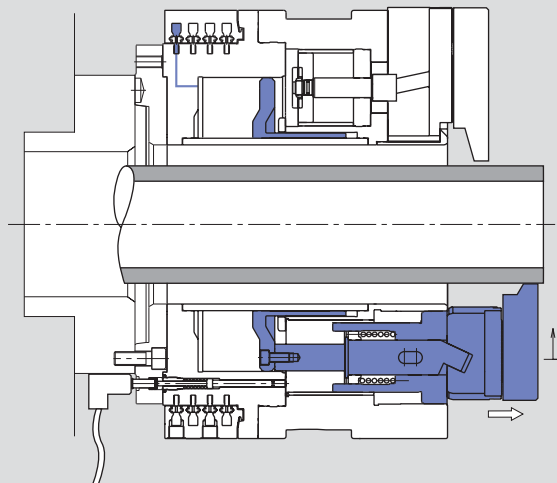

Centering jaws move forward axially to center the pipe at the threading area

3

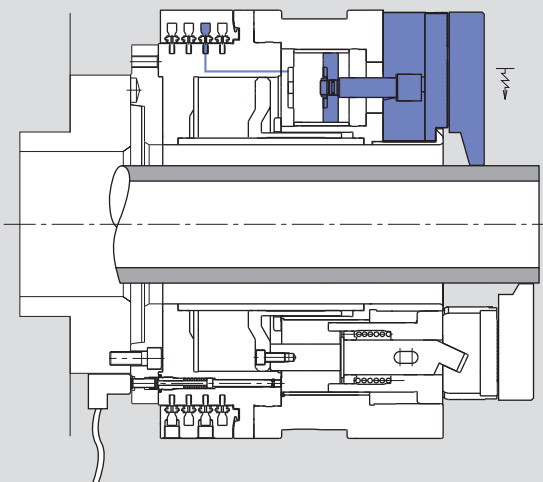

Compensating jaws pick up the pipe in the centered position

4

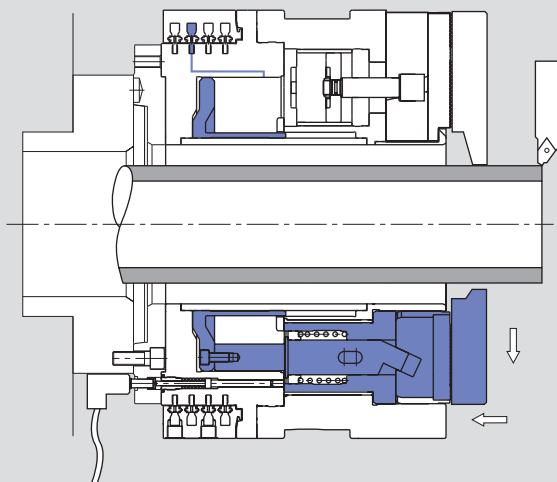

Centering jaws open and retract back axially into the chuck body. The pipe can now be machined.