

# Stationary cylinder + chuck unit Ø 80 - 315 mm

## US-CL

## US-A

- hydraulic cylinder module + chuck
- closed center chucks type CL/AN/AL

With 2 jaw long stroke chuck

With 3 jaw long or normal stroke chuck

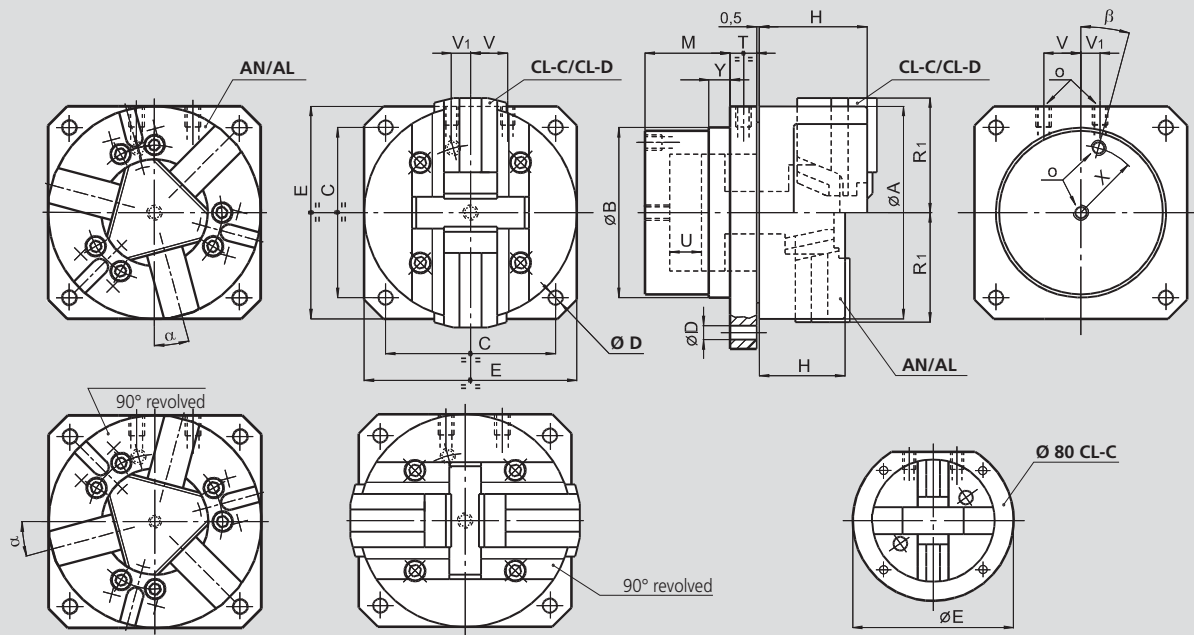

Subject to technical changes  
For more detailed information please ask for customer drawing

### US actating cylinder dimensions

SMW-AUTOBLOK cylinder		US 80	US 100	US 125	US 160 US 165	US 200	US 250	US 315
<b>Id. No.</b>		77755008	77755010	77755013	77755016	77755120	77755025	77755031
<b>B h7</b>	mm	70	84	106	128	158	185	185
<b>C</b>	mm	66	84	104	130	160	200	250
<b>D</b>	mm	7	9	11	11	13.5	17	17
<b>E</b>	mm	105	100	130	160	200	250	315
<b>M</b>	mm	45	52	60	70	80	90	90
<b>O</b>	oil connections	inch 1/8 BSP	1/8 BSP	1/4 BSP	1/4 BSP	3/8 BSP	3/8 BSP	3/8 BSP
<b>T</b>	mm	16	16	20	20	25	25	25
<b>U</b>	mm	11	14	20	25	30	35	35
<b>V</b>	mm	15	18	12	28	35	41	41
<b>V1</b>	mm	15	18	12	15	18	15	15
<b>X</b>	mm	27	33	43	52	63	75	75
<b>Y</b>	mm	10	10	10	20	20	20	20
<b>β</b>	deg.	30°	30°	15°	15°	0°	0°	0°
<b>Piston area</b>	cm <sup>2</sup>	16	25	42	68	112	166	166

### Units with CL-C and CL-D chucks (more information at page 56)

SMW-AUTOBLOK Type		US 80-CL-C	US 100-CL-C	US 125-CL-C	US 160-CL-C	US 200-CL-D	US 250-CL-D	US 315-CL-D
<b>A</b>	mm	80	100	125	160	200	250	315
<b>H</b>	mm	45	54	76	92	103	109	114
Chuck open	<b>R1</b>	mm 40	50	68	87	108	132	166
<b>Max. pressure</b>	bar	38	36	36	37	32	30	36
<b>Max. gripping force</b>	kN	9	14	24	40	55	78	95

### Units with AN-D/AN-M/AN-C chucks (more information at page 22 and 26)

SMW-AUTOBLOK Type		US 125-AN-D US 125-AN-M	US 165-AN-D US 165-AN-M US 165-AN-C	US 210-AN-D US 210-AN-M US 210-AN-C	US 250-AN-D US 250-AN-M US 250-AN-C	US 315-AN-D US 315-AN-M US 315-AN-C
<b>A</b>	mm	127	165	210	254	315
<b>H</b>	mm	57	71	85	95	105
Chuck open	<b>R1</b>	mm 64	83	105	128	158
<b>α</b>	deg.	0°	15°	15°	15°	15°
<b>Max. pressure</b>	bar	47	36	31	28	36
<b>Max. gripping force</b>	kN	56	70	105	140	180

### Units with AL-D/AL-M chucks (more information at page 24)

SMW-AUTOBLOK Type		US 125-AL-D US 125-AL-M	US 165-AL-D US 165-AL-M	US 210-AL-D US 210-AL-M	US 250-AL-D US 250-AL-M	US 315-AL-D US 315-AL-M
<b>A</b>	mm	127	165	210	254	315
<b>H</b>	mm	57	71	85	95	105
Chuck open	<b>R1</b>	mm 67	86	109	133	164
<b>α</b>	deg.	0°	15°	15°	15°	15°
<b>Max. pressure</b>	bar	60	44	45	39	45
<b>Max. gripping force</b>	kN	45	54	90	120	135

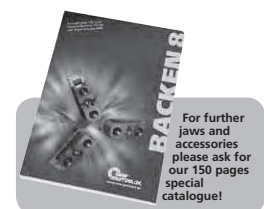

For further jaws and accessories please ask for our 150 pages special catalogue!