

# Grippers UGE



For further jaws and accessories please ask for our 150 pages special catalogue!

## The economical solution: Roughing jaws with exchangeable grippers

- Made from standard SMW-AUTOBLOK jaws.
- Economical, because only the worn out gripper is changed in seconds.
- Extended life compared to standard roughing jaws.

## Features:

- Safe gripping of raw material/forgings/castings made from standard or high tensile strength material.
- Increased gripping allows heavier cuts.
- Fast change of worn out grippers.

### UGE 10 Id. No. 081845F Hardened Steel

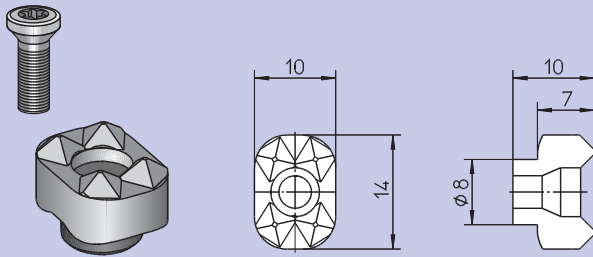

Parts included: Gripper with Torx screw

### The universal gripper with unique features (patented):

- For flat and round clamping surfaces
- For external and internal gripping
- Front mounting of bolts
- Gripper seat, round or flat, and thread is easy to produce
- Hardening of gripper seat necessary
- Torx screw driver Id. No. 085961
- Torx screw M4 x 13.5 Id. No. 033010

### Mounting instruction

1. Part  $\varnothing D + 6$  mm (0.23 inch) + location + slot has to be turned or milled. Please note corrected dimensions according to sketch.
2. Drill and tap
3. Harden jaw

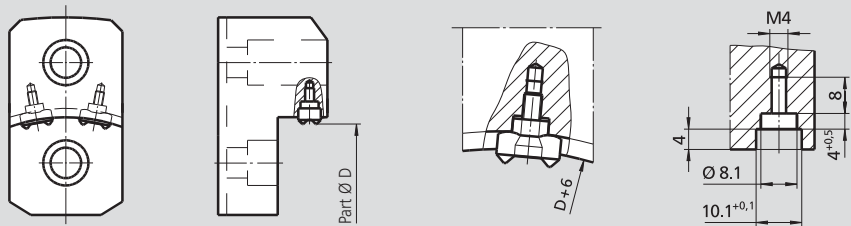

### UGE 20 Id. No. 087414 Hardened Steel

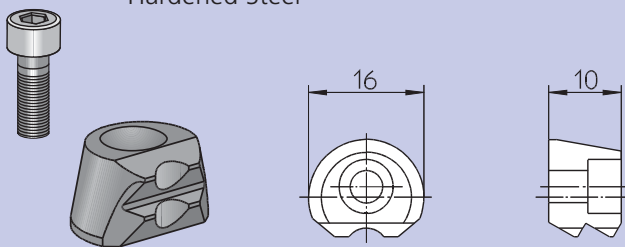

Parts included: Gripper with head socket screw M4 x 12 DIN 912

### The gripper with the unique shape (patented):

- Top mounting of bolt
- Pull-down effect by wedge shape design
- Can be used for self-centering or swivelling
- Gripper seat: Milling, drilling and tapping can easily be machined with the inclined milling tool (033611)
- No hardening of jaws necessary
- For external or internal clamping
- Head socket screw M4 x 12 DIN 912, Id. No. 010145

### Mounting instruction:

1. Part  $\varnothing D + 4$  mm (0.16 inch) + location turning or milling
2. Milling of pocket + drilling and tapping

Inclined milling tool  
Id. No. 033611

