

Precision gripper

G15 + G30 for highest torque transmission

G15 + G30

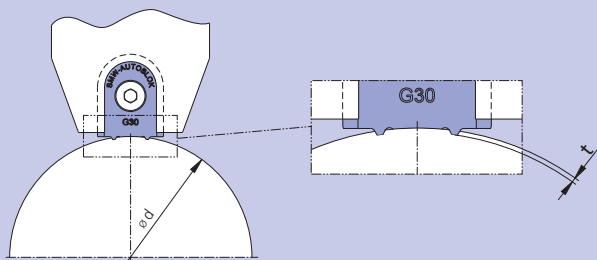

G-gripper characteristics

- Type G grippers have a stop surface for a **controlled penetration** of the grip tooth.
- **The workpiece is clamped concentric on the stop surface**, so that the clamping dia. and the machining dia. are concentric.
- The **high precision** of the gripper guarantees concentricity even after replacing worn out grippers.
- Highest torque transmission is guaranteed with the **combination of friction and positive drive**.
- **TIN coated high speed steel** for long life.
- You can **select the corresponding gripper** for all applications according to the grindstock allowance.
- Gripper with **controlled penetration 0.15–0.30 mm** are standard.
- **Special grippers are available** on request.

G15 (light duty version)

material: HSS

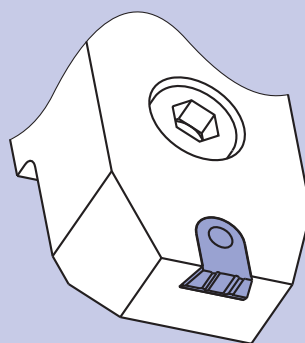
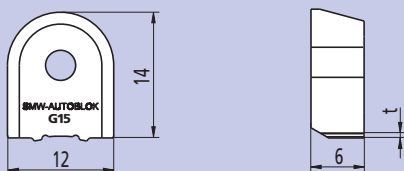

SMW-AUTOBLOK type	G15-150	G15-200	G15-250
Work piece-Ø		17 - 21	
Controlled penetration t	0.15	0.20	0.25
Id. No.	235621	235622	235623
SMW-AUTOBLOK type	G15-150	G15-200	G15-250
Work piece-Ø		22 - 27	
Controlled penetration t	0.15	0.20	0.25
Id. No.	237762	237763	237764
SMW-AUTOBLOK type	G15-150	G15-200	G15-250
Work piece-Ø		28 - 34	
Controlled penetration t	0.15	0.20	0.25
Id. No.	235624	235625	235626
SMW-AUTOBLOK type	G15-150	G15-200	G15-250
Work piece-Ø		35 - 42	
Controlled penetration t	0.15	0.20	0.25
Id. No.	237765	237766	237767
SMW-AUTOBLOK type	G15-150	G15-200	G15-250
Work piece-Ø		43 - 53	
Controlled penetration t	0.15	0.20	0.25
Id. No.	235627	235628	235629
SMW-AUTOBLOK type	G15-150	G15-200	G15-250
Work piece-Ø		54 - 78	
Controlled penetration t	0.15	0.20	0.25
Id. No.	237400	237401	237402
SMW-AUTOBLOK type	G15-150	G15-200	G15-250
Work piece-Ø		79 - 175	
Controlled penetration t	0.15	0.20	0.25
Id. No.	237409	237410	237411

Mounting dimension

